



S I S T J a p a n L a n g u a g e C o l l e g e

学校法人 静岡理工科大学

浜松日本語学院

Hamamatsu Japan Language College

学校法人 静岡理工科大学

沼津日本語学院

Numazu Japan Language College

School Guide



Not Only Japanese Language



HAMAMATSU

Hamamatsu and Numazu are located in the center of Japan.

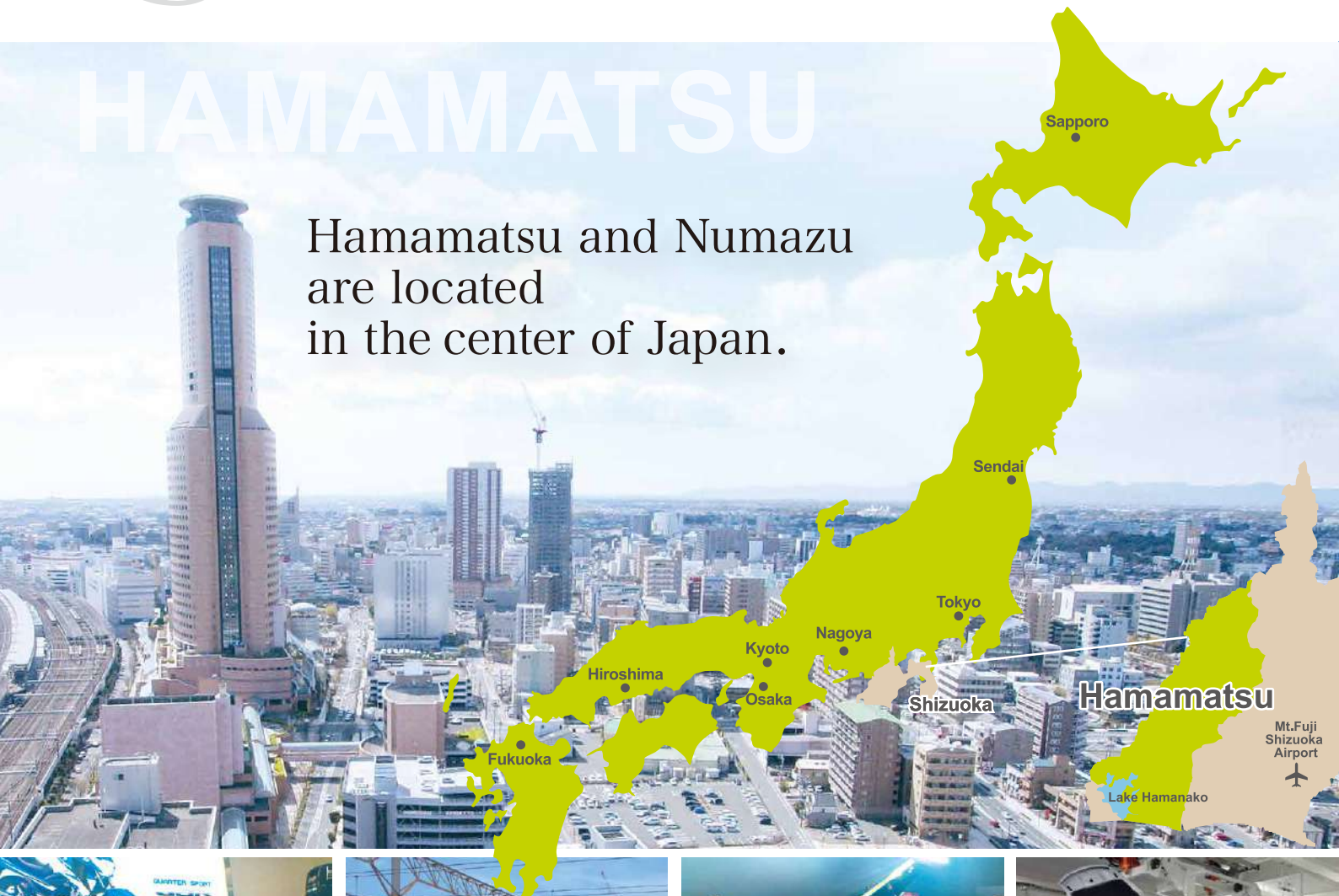

About HAMAMATSU CITY

- ▶ Hamamatsu is an ordinance-designated city which has a population of 820,000.
- ▶ Prices in Hamamatsu are lower than those in Tokyo or Osaka, and it's the very livable city.
- ▶ It is a safer city.
- ▶ It takes 1 hour and 20 minutes to Tokyo, and 45 minutes to Nagoya by bullet train.
- ▶ Hamamatsu is blessed with nature such as hot springs, a big lake, sea, mountains and rivers. Its climate is mild with a lot of hours of sunlight.
- ▶ Hamamatsu is the birthplace of worldwide large companies such as Honda, Suzuki and Yamaha. Industries of the city are prosperous.
- ▶ There are many higher educational institutions such as universities, graduate schools, and junior colleges. Hamamatsu is the prospered city of education.
- ▶ The city offers a number of traditional events such as the Hamamatsu Festival and so on.



UJIMA COLLEGE



About NUMAZU CITY

- ▶ Numazu is a central city in the eastern part of Shizuoka Prefecture, and the gateway to Izu.
- ▶ Prices in Numazu are lower than big cities, and it's the very livable city.
- ▶ Numazu is a safer city.
- ▶ You can transfer trains to Mishima and it takes only 1 hour from Mishima to Tokyo by bullet train.
- ▶ Numazu city is blessed with nature such as Mt. Fuji in the north, Suruga Bay in the south, and Kano River flows into the middle of the city.
- ▶ Numazu is a land with mild climate and suitable for swimming in the summer, and for hiking in the spring and autumn.
- ▶ It is famous for fishery processing industries including dried fish.
- ▶ You can enjoy Japanese culture such as lantern banquet, fireworks and Yosakoi Dance.



Overview of SIST Group

Shizuoka Institute of Science and Technology Group is a comprehensive academic system consisting of Shizuoka Institute of Science and Technology as its core school, together with 2 senior high schools, 2 junior high schools, 6 vocational colleges and 2 Japanese language colleges. Since 1940, when it was established with the founding motto of “Contributing to regional communities through the development of technicians,” the schools have produced many exceptional talents. Its guiding educational principle is “Fostering a higher degree of expertise and richness of spirit,” and the quality of education continues to be improved by leveraging the benefits of the academic group network.



※Shizuoka Professional College of Automobile Technology is a sister institution of our group.

33 Fields You Can Learn in the SIST Group

Vocational Colleges (Fields of Industry)



Computer



CG Animation

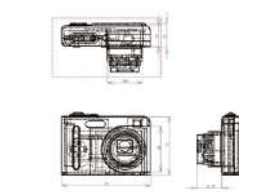

CAD



Web Design

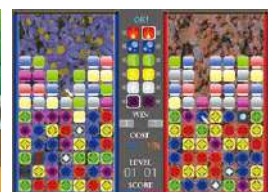

Game Creation



Automobile



Robot



Architecture



Security Network

Vocational Colleges (Fields of Education, Social Welfare and Commercial Practice)・(Fields of Clothing, Culture, Education and Health)



Hotel / Tourism



Cabin Attendant



Medical Clerk



Business / Public Servant



Childcare



Caregiving



Bridal



Fashion



Interior / Flower



Makeup/ Nail Art



Language



Pastry (Patisserie)



Graphic Design



Product Design

University (Science and Technology)



Mechanical Engineering Robotics



Mechanical Engineering Aerospace



Electrical and Electronic Engineering
Information and communication field



Material and life science
Light application/Electric Device



Material and life science
Environment new material

University (Science and Technology)



Material and life science
Bio/Food science



Architecture



Civil Engineering



Computer system



Information Design

University (General Information)

College Facilities

Hamamatsu Japan Language College



Numazu Japan Language College



Features of HJLC and NJLC

After finishing Hamamatsu Japan Language College (HJLC) / Numazu Language College (NJLC), it is possible for you to go to Shizuoka Institute of Science and Technology or Vocational Colleges in the SIST group by utilizing the group capability. In the case of enrollment from our school there are benefits such as exemption of entrance examination fee, entrance fee, discount tuition fee, and recommendation entrance.

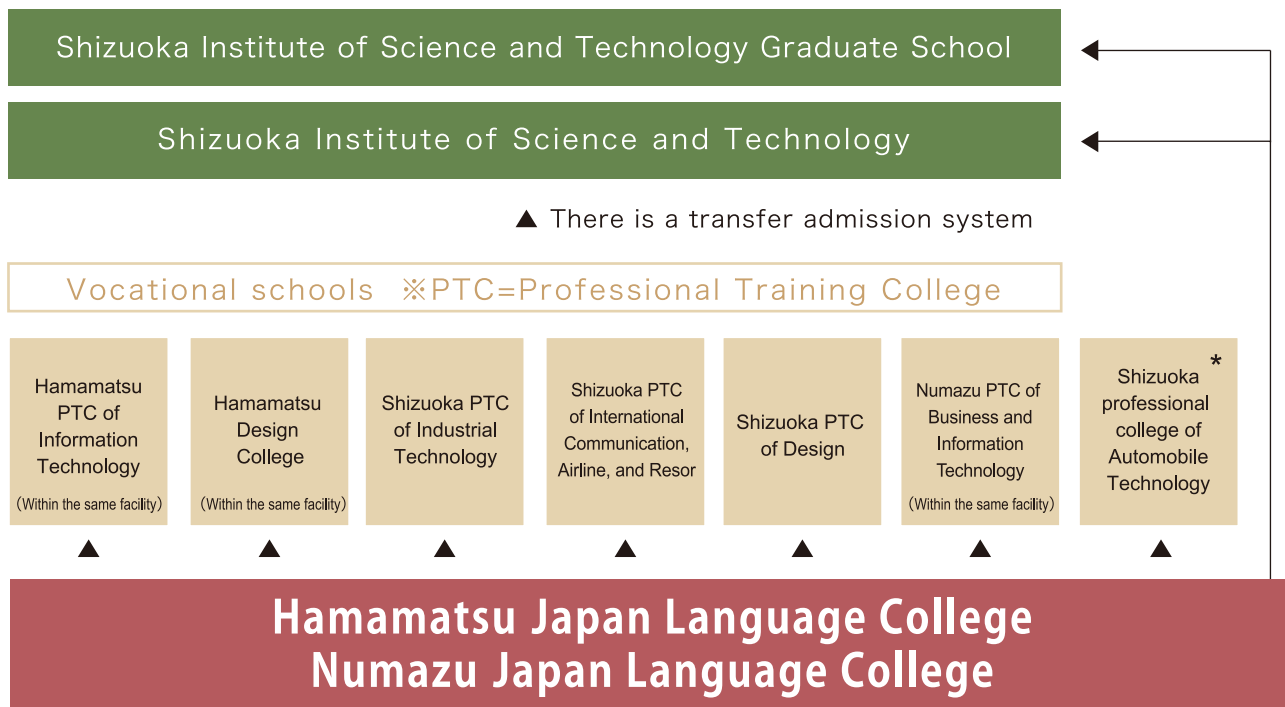

※Shizuoka professional college of Automobile Technology is a sister educational institution of our educational institution.



Profitable tuition

Students entering a group school are exempt from entry exam and matriculation fees.

(JPY)

Shizuoka Institute of Science and Technology	Applicants	Entrance Exam Fee	Admission Fee	Annual Tuition (1 year)
	In general	30,000	300,000	1,240,000
	From HJLC/NJLC	Exempt	Exempt	750,000

Vocational school in the group	Applicants	Entrance Exam Fee	Admission Fee	Annual Tuition (1 year)
	In general	22,000	250,000	920,000
	From HJLC/NJLC	Exempt	Exempt	600,000

※Entrance examination fee and admission fee for Shizuoka Professional College of Automobile Technology (Department of Auto Mechanics) will be exempted. Basically, tuition fee is 780,000 yen per year but you will receive lodging subsidy (120,000 yen), so the actual tuition fee will be 660,000 yen per year.



Advantageous entering and employment

That's one of the advantages of attending a group school.

After graduation, you can go to the university and vocational schools of our group like SIST. There is a recommendation system for entry.



Advantageous living expenses

Good living environment in Shizuoka

In Tokyo, rent of apartment will take about 70,000yen per month, but rent of furnished apartment cooperating with HJLC is 17,100yen. In addition, life consultant is always staying at the school.

Outline of courses / Class Schedule

2-year College Preparation Course<April Entrance> / 1600 hours (400days)

Apr	May	Jun	Jul	Aug	Sept	Oct	Nov	Dec	Jan	Feb	Mar
Elementary 1			Elementary 2			Intermediate 1			Intermediate 2		
Apr	May	Jun	Jul	Aug	Sept	Oct	Nov	Dec	Jan	Feb	Mar
Advanced 1 / Step for exam			Advanced 2 / Step for exam					Advanced 3 / Step for exam			

1-year and 6 months College Preparation Course<October Entrance> / 1200 hours (300days)

Apr	May	Jun	Jul	Aug	Sept	Oct	Nov	Dec	Jan	Feb	Mar
						Elementary 1		Elementary 2		Intermediate 1	
Apr	May	Jun	Jul	Aug	Sept	Oct	Nov	Dec	Jan	Feb	Mar
Intermediate 1		Intermediate 2 / Step for exam			Advanced 1 / Step for exam			Advanced 2 / Step for exam		Advanced 3 / Step for exam	

◆Class Schedule

※Elective classes are started from 3rd period at the Afternoon course.

Morning course			Afternoon course		
1st period	09 : 10 ~ 09 : 55	Japanese	3rd period	10 : 55 ~ 11 : 40	Elective class
2nd period	10 : 00 ~ 10 : 45	Japanese	4th period	11 : 45 ~ 12 : 30	Elective class
3rd period	10 : 55 ~ 11 : 40	Japanese	5th period	13 : 10 ~ 13 : 55	Japanese
4th period	11 : 45 ~ 12 : 30	Japanese	6th period	14 : 00 ~ 14 : 45	Japanese
5th period	13 : 10 ~ 13 : 55	Elective class	7th period	14 : 55 ~ 15 : 40	Japanese
6th period	14 : 00 ~ 14 : 45	Elective class	8th period	15 : 45 ~ 16 : 30	Japanese

◆Elective Subject

① Japanese subjects (Free)

Speech, Pronunciation, Things Japanese, Kanji, Reading comprehension, etc.

② Step for EJU (Free)

Mathematics, Social Studies (General subject), Japanese, Science and English.

③ Attend vocational school lesson (Free)

"Hamamatsu Professional Training College of Information Technology" "Hamamatsu Design College"

"Numazu Professional Training College of Business and Information Technology" (Game Creation, Graphic Design, Makeup, Fashion, etc.)

④ Applicants of Shizuoka Institute of Science and Technology or its graduate school (Free)

Attend university classes

(Mechanical Engineering, Electrical and Electronic Engineering, Material and Life Science, Computer Science, Information Design, Architecture, etc.)

◆Curriculum

The characteristics of our Japanese language education are based on textbooks and curriculums of "Dekiru Nihongo. We aim to master "ability to communicate" to disseminate in Japanese itself, "ability to think", and ability to talk to understand with others. In order to connect with people and society, it is necessary to communicate with each other and exchange each other while talking. In our school, we conduct not only learning in the classroom but also various forms of communication activities and learning Japanese culture, customs and human relations through Japanese. And we aim to acquire true "Japanese ability", "academic ability", "Human ability" and to select the course that students can choose.



List of Payment (Tuition fee and Rent of Apartment, Scholarships)

	First Year	Second Year	
Tuition Fee	All Course	April Admission Course	October Admission Course
Entrance Formalities Fee	100,000yen	0	0
Entrance Exam Fee	22,000yen	0	0
Tuition Fee	600,000yen	600,000yen	300,000yen
Textbooks & Materials	50,260yen	50,260yen	25,130yen
Japanese school student accident compensation system	15,740yen	15,740yen	7,870yen
Total	788,000yen	666,000yen	333,000yen

	First Year ※1~4	Second Year ※1~4	
Residence Fee	All Course	April Admission Course	October Admission Course
Four Persons Room 20,000yen / Month	240,000yen	240,000yen	120,000yen
Three Persons Room 22,000yen / Month	264,000yen	264,000yen	132,000yen
Two Persons Room 25,500yen / Month	306,000yen	306,000yen	153,000yen
One Person Room 47,000yen / Month	564,000yen	564,000yen	282,000yen
Comprehensive Compensation For International Student Housing (For One Year)	4,000yen	4,000yen	2,000yen
OFUTON (Bedding) Fee	12,000yen	0	0
Cleaning Fee When Leaving	25,000yen	0	0
Total	281,000yen ~ 605,000yen	244,000yen ~ 568,000yen	122,000yen ~ 284,000yen

Total Annually (Tuition Fee + Residence Fee)

1,069,000yen ~ 1,393,000yen

【※1】 In the apartment, it has already prepared lighting, refrigerator, desk, chair set, all including. 【※2】 Apartment fee would depends on each room. 【※3】 If the room & furniture broken, shall be incurred the payment. 【※4】 Reference for each one of monthly payment is about 38,500 yen, details are Food expenses (25,000yen ~ /month)、Smart phone (5,000yen ~ /month)、Utility costs (Electricity 3,000yen ~、Gas 3,000yen ~、Water 2,500yen ~) /Month. 【※5】 Payments may be refunded if the principal deems there is a special reason who has declined admission in case.

◆ Scholarships of Hamamatsu, Numazu Japan Language College <Special scholarships as follows>

Name of scholarships	Application Status	Start Scholarship	Amount of Scholarship
Scholarships for Designated schools ※	Students who was recommended by designated agents	At the time of entrance	~122.000 JPY
Scholarship for Special Students	Students who pass scholarship	During attendance	150.000~600.000 JPY / for a year
Prize for Excellence	Students who have excellent school record	During attendance	~20.000 JPY

◆ Designated scholarships <The following public scholarships have been designated as schools>

Name of Scholarship	Application Status	Start Scholarship	Amount of Scholarship
Mext, Ministry of Education, Culture, Sports, Science and Technology (MEXT)	Applicable	Second Year	30,000yen/ month
Kyoritsu Maintenance Scholarship Fund Scholarship	Applicable one person (Number of 35 people for All Japan)	Second Year	60,000yen/ month
LSH Asia Scholarship (Li Hideken Honoring Scholarship) Scholarship	Applicable (Number of 40 people for All Japan)	First、Second Year	100,000yen (once a year)

The author made the textbooks over 10 years with her own practice at the educational interface and she herself gives us lectures.



Profile: Ms. Shimada Kazuko

- ◎General Incorporated Association: Director of ACRAS Japanese Language Institute
- ◎Public Interest Incorporated Association:
Vice Chairman of the Institute of Japanese Education
- ◎Counselor of Hamamatsu Japan Language College
and Numazu Japan Language College ◎Trainer of ACTFL-OPI

<Books>

Book Series: "DEKIRU NIHONGO" (Supervised) ACL PRESS INC. BONJINSHA
 "Aim for Improving Japanese Lectures' Strength—lively classes with Oral Proficiency Interview" HITSUJI SHOBO
 "Raising Proficiency—Aiming for True Japanese Language Ability " BONJINSHA
 "Proficiency and Japanese Language Education" HITSUJI SHOBO
 "Dialogue and Proficiency" HITSUJI SHOBO
 "Discourse and Proficiency" BONJINSHA / Other Publishing Company

◆ Additional Course: Teacher Training Course of Japanese Language

Basic Course (420 hours as time unit)

"Japanese Teacher Training Course" (420 unit time course) of Hamamatsu Japan Language College is a new standard course accepted by the Agency of Cultural Affairs.
Notification number 29052622002

Major Course (Practical Course)

We will place a completion officer (mentor) to each graduate student who completed the basic course (including those who completed 420 hours at other schools and those who passed the Japanese Language Teaching Competency Test), implementing and instructing practical skills and exercises.

School life support

▶ Health insurance

Students are supposed to join the Comprehensive Insurance of Association for the Promotion of Japanese Language Education along with the national health insurance. It will have reduced cost of medical expenses.

▶ Student commuter pass

Students can receive various kinds of student discounts such as commuter pass, school discount for JR long-distance students.

▶ Homestay Program

Students can enjoy staying at Japanese family's homes during summer vacation. It's a program for experiencing Japanese lifestyle, customs and Japanese language.

▶ Career Counseling and Life Advice, School Counselors

In both schools, we are able to provide extracurricular lessons, lifestyle guidance, daily necessity items, part-time job information, short-term homestay, cultural exchange meetings, donations, and more.

▶ Association for the support of overseas students at our Japan Language

College Thanks to our volunteers, we are able to provide extracurricular lessons, lifestyle guidance, daily necessity items, part-time job information, short-term home stays, cultural exchange meetings, raise donations, and more.

▶ Part time job

Students can have a part-time job for 28 hours a week if they are able to obtain temporary work permission. You can make friends and learn how to get along with Japanese people through part-time jobs as well as make a living. There is a special staff for introducing part-time jobs in two schools, so please feel free to contact us.



Apartment

► Lodgings

Off-campus apartment housing is available in 20 minutes away by bicycle from campus.
It is affordable, safe, and convenient.

Single room for one or two persons

Rent: from 34,320JPY / month~ / 17,160 JPY / month~ (per person)



An excellent location close to the heart of downtown!



Lots of natural sunlight!

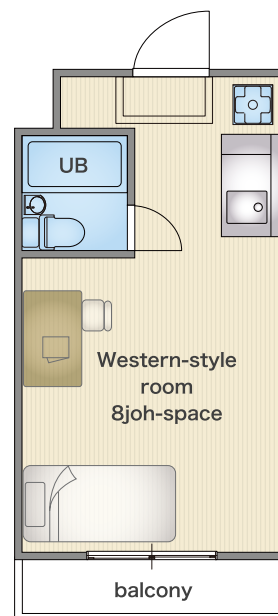

Single room for 2 to 4 persons

Rent: from 14,620JPY / month~ / 27,160 JPY / month~ (per person)



It's safer—and more fun!—to live with a roommate!

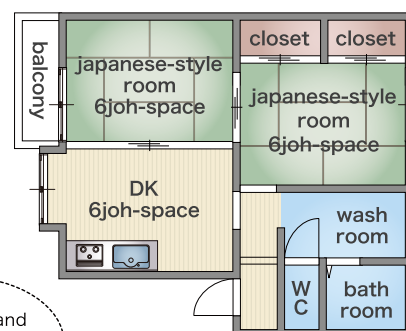

Year-round Schedule & Campus Life

You must understand Japanese life and culture if you want to learn Japanese language more deeply. Various activities and events are provided throughout the year so that you can learn and understand Japanese culture with fun.

SCHEDULE

Spring Excursion



Going to Nagashima Spa Land!

4

April

5

May

● Spring Excursion

6

June



Factory tour



Impressed by the robot movements

7

July

- Star Festival
- Summer school
- Factory tour to Yamaha and Honda

8

August

9

September

Let's enjoy dress up for halloween

● Halloween Party

10

October

11

November

● Autumn excursion

12

December

● Christmas Party

1

January

- New Year's experience
- Sports festival

2

February

- Setsubun (Bean-Throwing)
- Speech contest
- Culture festival

3

March

- Graduation ceremony
- Student presentations

Sports festival



Exciting! Amazing cheers!

Speech Contest



Showing the results of my studies!

Fun events all year round!



Autumn excursion



A fun field trip!

Graduation ceremony



Tears and emotions at our graduation ceremony♪



We provide a variety of events aimed at promoting the creation of a multicultural society in Hamamatsu and Numazu. Students can enjoy a fulfilling student life by participating in school life events, which allow them to deepen their understanding of Japan and create strong friendships with students from all over the world.

LIFE STYLE LIFE IN JAPAN - THE VOICE OF OUR COLLEGE STUDENTS -



Vietnam Enrolled in the College in April 2014
PHAM THI PHUONG QUYEN
Part-time Jobs Help you Learn Japanese!

Since arriving in Japan, I have been studying Japanese and doing part-time jobs. The school told me about a part-time job as a waiter in a hotel. Thanks to this job, I can meet and speak with Japanese people. I believe that speaking with Japanese people every day helps me improve my Japanese. In particular, the hotel staff are always enthusiastic when explaining to me anything about Japanese, or anything else that I do not understand. The people at the hotel where I work are very kind, but I feel that actually everybody in Japan is very friendly toward foreign language students. I can only work for four hours every day, but I am always looking forward to it. If you come to Japan, I definitely recommend getting a part-time job.



I have a part-time job at a hotel.

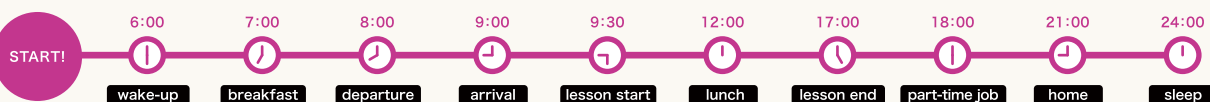

The Voice of our Seniors (Graduates)



►China LIU XIAOYI

ANA NARITA AIRPORT SERVICES CO.,Ltd. Graduated in March 2016

Challenge and grasp the dream

I am currently working as an international airline ground staff ANANarita Airport Service Co., Ltd., mainly focusing with check-in procedure at the counter for customers preparing for departure and arrival at the gate. One of the main focuses that I've learned back in school that is helping to put my experiences at work is the spirit to "continue challenging". A professor from Hamamatsu Japan Language College has always encouraged me never to give up as "something better will definitely waiting for you". Since then it has become my motto to "continue challenging" without giving up no matter how difficult you confront with something. The advice I would like to share for new incoming students is to make sure to have a vision for your future goals and not to think of your present appearance. In order to further improve the communication skills with customers, I would like to travel many foreign countries to expand my horizons, which will be helpful to my future work experiences.

Graduates

VOICE.1



►Vietnam DO MANH TUONG

Nett TOYOTA Hamamatsu Co., Ltd. Graduated in March 2015

Pursue your Dream from the Leading-edge Technology

As I spot many Japanese vehicles in Vietnam, I had a passion to become an automobile engineer. In order to pursue my goal, I entered Hamamatsu Japanese Language College to study and become proficient in Japanese. The lecturers' lessons were very entertaining and easy to understand, thus I was able to absorb Japanese quickly. After graduating from Hamamatsu Japan Language College, I entered Shizuoka Professional College of Automobile Technology and passed the grade 2 of Professional Certification for Toyota Auto Mechanics. My future goal is to pass the Grade 1 of mentioned test and move on to my next step to become an executive head for Motors in Vietnam. If you are planning to study abroad, please come and learn the language at Hamamatsu Japan Language College and seek for your dream.

Graduates

VOICE.2



►Sri Lanka KC Namal

Hamaguchi Urethane CO.,LTD. Graduated in March 2016

The Value of Human Relationship

I am currently employed at Hamaguchi Urethane, Co., Ltd as a quality inspection assistant for armrests and headrests for automobiles and also conduct sales for urethane based boats. Our company participate various exhibitions held in overseas where I would like to seek my goal to work in international sales division to expand Japanese industrial technologies to foreign countries. One of the things I've learned at Hamamatsu Japan Language College aside of the language is the importance of how to build a good relationship and respect other people. Gaining trust is the key issue to live here in Japan, especially when dealing with time. My advice for incoming students is to make sure to follow the time you confirmed and never be late. It is essential for all students to re-acknowledge the purpose of studying in Japan and not to forget about the dream and goals you are aiming for.

Graduates

VOICE.3



►Taiwan LIANG CHIHWEI

Associa Hotels & Resorts Graduated in March 2014

The true attraction of Hospitality

I was able to study abroad and enroll Hamamatsu Japan Language College because my friend in homeland gave me advice to study in Japan if I am truly thinking about working and living in Japan. I sincerely thank my friend for his opinion as I was successfully able to enter Shizuoka Professional Training College of International Communication, Airline and Resort to learn the depth of Japanese manners, hospitalities, and the culture. After completion from above college, I am currently working as a receptionist at Hotel Associa Shizuoka. At first, my assumption to this work duty was simply to manage luggage stored by customers and guide them to their rooms, however the actual job responsible ranges from arrival greetings, provide tour information, and arrange cabs to our hotel gate. Japanese hospitality, known as Omotenashi, is the main appeal upon working at this work site. The skills and knowledge learned from Hamamatsu Japan Language College are very useful especially in the field of hotel and management. I sincerely hope to provide the best hospitality and make proposals that our customers will be pleased.

Graduates

VOICE.4

Group Overview

Greeting

A New Japanese Language Education Towards A New Era

Hamamatsu Japan Language College (HJLC) and Numazu Japan Language College (NJLC) are located in the center of Japan, Shizuoka Prefecture. It has not only a lot of mechanical industries such as YAMAHA and SUZUKI, and is also famous for its spectacular natural beauty. The educational goal of both schools is to be better colleges to accept international students who wish to go on to universities in Japan, graduate schools, vocational colleges, and to guide students to learn how to live in Japan and Japanese language in a precise manner with detailed guidance. The feature is in education collaboration that utilizes the group capabilities of Shizuoka Institute of Science and Technology. For example, there is a "purpose-oriented lesson system" that allows students to freely select classes of computer / CAD and other fields of professional training colleges in the same school building. In addition, you can enjoy fun trips and sports events with Japanese students from other affiliated schools and by these exchange programs, this kind of environment gives them practical usage of Japanese. In course determination, we provide many courses not only for passing the Examination for Japanese University Admission for International Students (EJU) and Japanese Language Proficiency Test, but also for passing highly-selective universities in Japan. It is our great pleasure to see all the students of our colleges go on to universities, graduate schools or vocational schools in Japan, and to further study at Japanese companies and contribute to the development of their own countries.



Hamamatsu Japan
Language College Principal

**Takeshita
Tomohiro**



Numazu Japan
Language College Principal

**Oishi
Masaaki**

SIST GROUP keeps moving with a Spirit of Foundation “To contribute to the community by nurturing technical expertise”

History of Shizuoka Institute of Science and Technology

May	1940	Shizuoka-ken Driving School opened
April	1956	Auto Mechanic Department is added to Shizuoka-ken Driving School
April	1963	Shizuoka -ken Automobile High School established
July	1970	Shizuoka Professional Training College of Industrial Technology is spun off from Shizuoka-ken Driving School
June	1977	Seiryō Senior High School joins the Group
April	1980	Shizuoka-ken Automobile High School is renamed Shizuoka Kita Senior High School
April	1983	Numazu Professional Training College of Information Technology opens
September	1984	Shizuoka Professional School of Culture joins the Group
April	1985	Hamamatsu Professional Training College of Information Technology opens
July	1990	Shizuoka Automobile Academy, an incorporated educational institution, is separated from the Incorporated educational institution, Shizuoka-ken Automobile Academy
December	1990	Shizuoka-ken Automobile Academy is renamed Shizuoka Institute of Science and Technology
April	1991	Shizuoka Institute of Science and Technology (SIST) commences operation
April	1996	SIST commences graduate programs
April	1997	Shizuoka Professional School of Culture is renamed Shizuoka Professional Training College of Design
April	2008	Shizuoka Professional Training College of International Communication, Airline, and Resort opens; Shizuoka Professional Training College of Design, Hamamatsu Campus opens
April	2010	Shizuoka Kita Junior High School opens; Numazu Professional Training College of Information Technology is renamed Numazu Professional Training College of Business and Information Technology
April	2011	Seiryō Junior High School opens
April	2011	Shizuoka Professional Training College of Design, Hamamatsu Campus is renamed Hamamatsu Design College
April	2011	Hamamatsu Japan Language College Opened (Admission Capacity: 100 students)
April	2014	Hamamatsu Japan Language College (Admission Capacity increased 150 students)
April	2015	Hamamatsu Japan Language College (Admission Capacity increased 225 students)
April	2017	Numazu Japan Language College (Admission Capacity 100 students)
April	2019	Hamamatsu Japan Language College (Admission Capacity increased 337 students)

For inquiries about enrollment at Hamamatsu Japan Language College and Numazu Japan Language College, please contact with the staff members of Entrance Exam in SIST Japan Language College Headquarters.

TEL 053-450-6590

E-mail office@hama-jlc.com



3-10-31 Chuo, Naka-ku, Hamamatsu-shi, Shizuoka
430-0929 JAPAN
TEL +81-53-450-6590 FAX +81-53-450-6591
E-mail office@hama-jlc.com
URL <http://www.hama-jlc.com/>



●Route Guide

▶ 8 minutes from Hamamatsu Station on foot.

▶ By car

15 minutes' drive from Hamamatsu IC

20 minutes' drive from Hamamatsu-nishi IC

▶ By train (Tokaido Shinkansen)

From Tokyo station to Hamamatsu station
Kodama 120 minutes, Hikari 90 minutes

From Shin-Osaka station to Hamamatsu Station
Kodama 115 minutes, Hikari 80 minutes

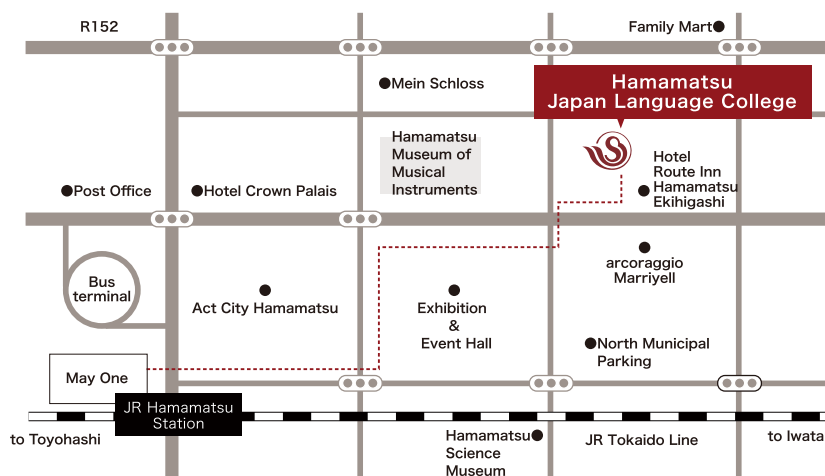

17-1 Saijo-cho, Numazu-shi, Shizuoka
410-0804, JAPAN
TEL +81-55-939-6590 FAX +81-55-939-6591
URL <http://www.hama-jlc.com/>

●Route Guide

▶ 5 minutes from Numazu Station on foot

▶ By car

15 minutes' drive from Numazu IC

▶ By train (Tokaido Shinkansen)

From Tokyo station to Mishima Station
→Kodama 52 minutes

From Mishima Station to Numazu Station
→6 minutes (one stop)

